

SAPONI
CONDENSING HOT WATER BOILER

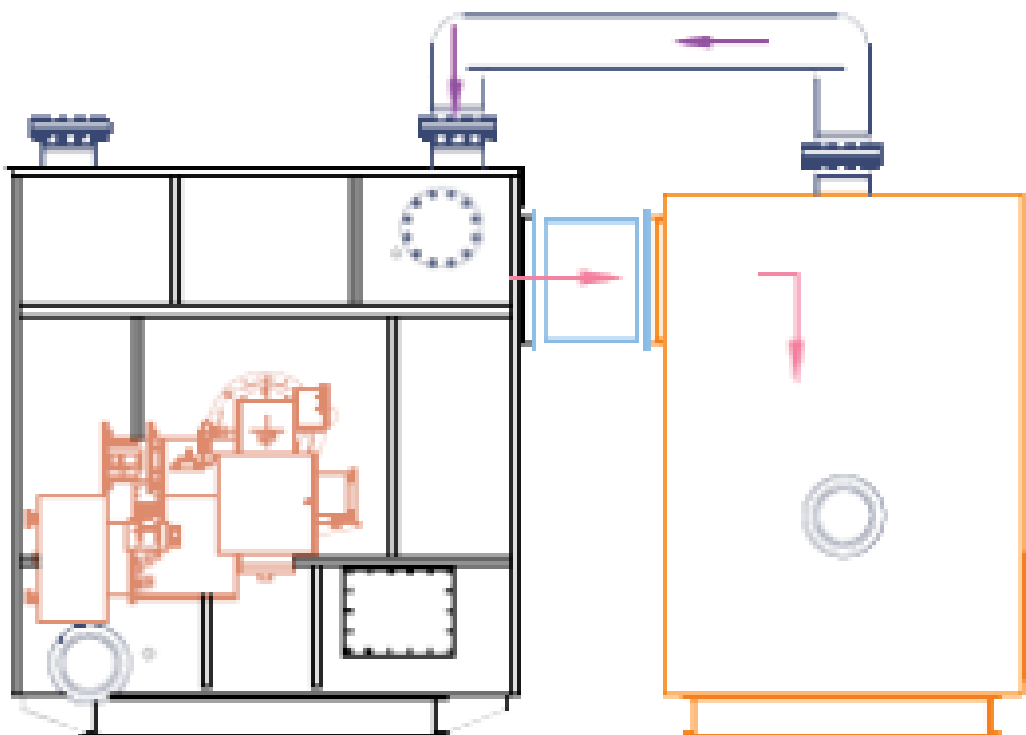

- ✓ High capacity watertube condensing hot water boiler integrating the patented DFW technology
- ✓ Maximum Allowable Working Pressure: 450 psig
- ✓ Sizes of 20, 25, and 30 MMBTU/hr
- ✓ Dual fuel capabilities with the ability to burn natural gas, fuel oil, digester gas, hydrogen, & various other gaseous fuels
- ✓ Offers increased heat transfer and absorption
- ✓ Lower heat flux
- ✓ Includes primary heat exchanger with stainless steel fins integral to the furnace module
- ✓ Full stainless steel secondary heat exchanger module
- ✓ Offers low waterside pressure drop
- ✓ Available with flexible condensing module location; can be located on the rear or on the side for optimized footprint
- ✓ Gas outlet configuration: rear or side

	LENGTH (A)	WIDTH (B)	HEIGHT (C)
20 MMBTU/HR	21' 4"	9' 0"	9' 0"
25 MMBTU/HR	22' 10"	10' 0"	9' 6"
30 MMBTU/HR	24' 6"	11' 0"	10' 6"



When it comes to boilers, flexibility and resourcefulness are king. Superior Boiler and our team of Superior Problem Solvers tackle your most complex boiler challenges so you can get down to business and keep the world running. We design and manufacture a complete line of boilers for all market segments. We build to our customers' exact standards at our facility in Hutchinson, KS, and our boilers are installed all over the world.



3524 E 4th Ave. / Hutchinson, KS 67501 / (620) 662-6693

SUPERIORBOILER.COM